



MPA ARCHITECTS, INC.
ARCHITECTS
PLANNERS
INTERIOR DESIGNERS

1801 CENTREPARK DR. E.
SUITE 175
WEST PALM BEACH
FL 33401

TEL (561) 683-7000
FAX (561) 478-3922

FL LIC AA-C000630

SEAL

JUPITER HIGH SCHOOL REPLACEMENT
SCHOOL DISTRICT PALM BEACH
PROJECT NO. 0081-8220

FLORIDA
JUPITER

Scale: 1"=80'-0"
Date: 3/07/03
Design By: R/J
Drawn By: R/J
Check By: R/J

FILE NUMBER
9510

REVISIONS
1. ISSUED FOR PERMITS
2. CLOUDED AREA ONLY
ENTIRE DWG NOT REVISION

REVISED MASTER
SITE PLAN

SP-1R
OF OF

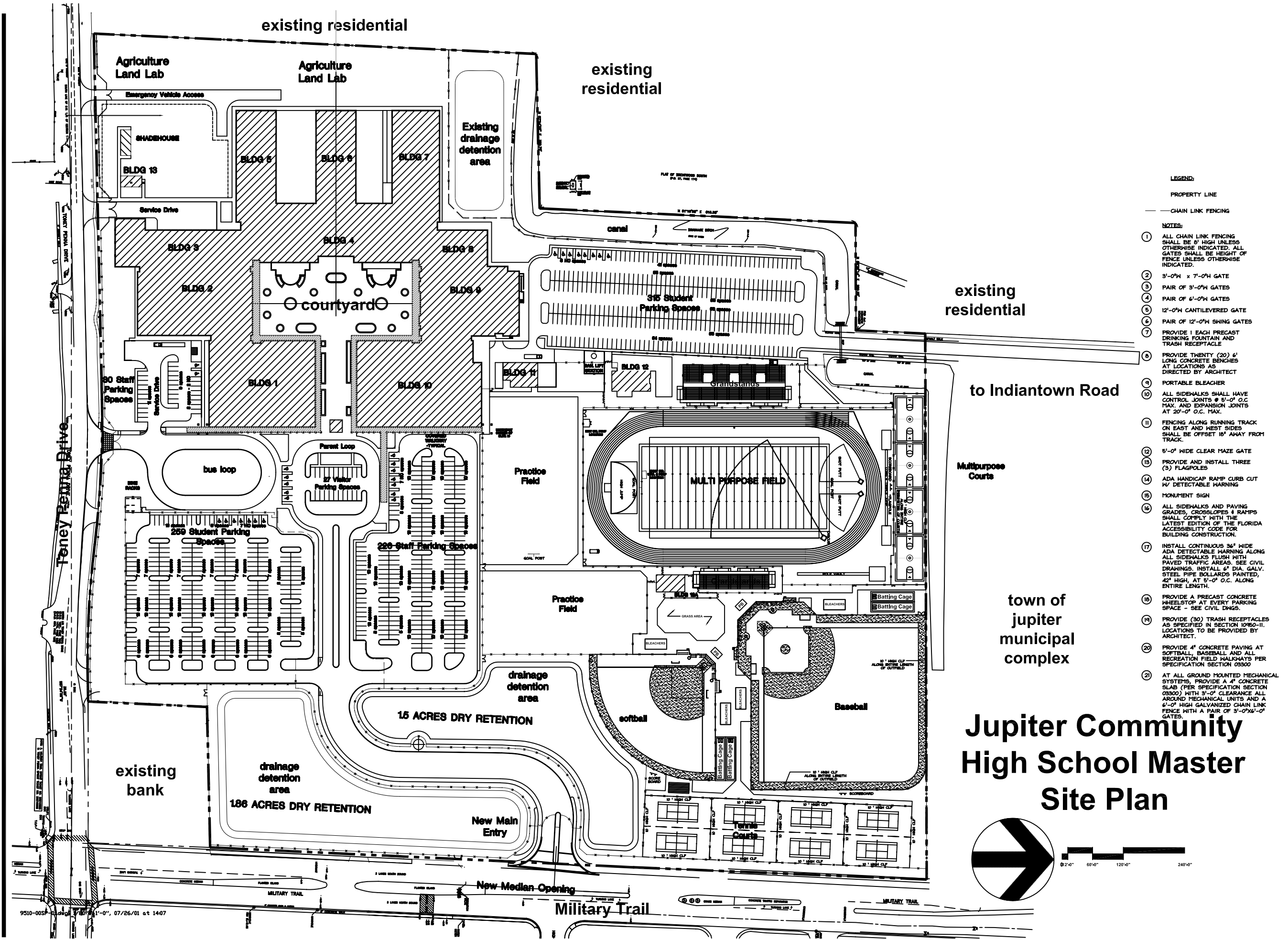

- LEGEND:**
- PROPERTY LINE
 - CHAIN LINK FENCING
- NOTES:**
- 1 ALL CHAIN LINK FENCING SHALL BE 8' HIGH UNLESS OTHERWISE INDICATED. ALL GATES SHALL BE HEIGHT OF FENCE UNLESS OTHERWISE INDICATED.
 - 2 3'-0" x 7'-0" GATE
 - 3 PAIR OF 3'-0" GATES
 - 4 PAIR OF 6'-0" GATES
 - 5 12'-0" CANTILEVERED GATE
 - 6 PAIR OF 12'-0" SWING GATES
 - 7 PROVIDE 1 EACH PRECAST DRINKING FOUNTAIN AND TRASH RECEPTACLE
 - 8 PROVIDE TWENTY (20) 6' LONG CONCRETE BENCHES AT LOCATIONS AS DIRECTED BY ARCHITECT
 - 9 PORTABLE BLEACHER
 - 10 ALL SIDEWALKS SHALL HAVE CONTROL JOINTS @ 5'-0" O.C. MAX. AND EXPANSION JOINTS AT 20'-0" O.C. MAX.
 - 11 FENCING ALONG RUNNING TRACK ON EAST AND WEST SIDES SHALL BE OFFSET 10' AWAY FROM TRACK.
 - 12 5'-0" WIDE CLEAR MAZE GATE
 - 13 PROVIDE AND INSTALL THREE (3) FLAGPOLES
 - 14 ADA HANDICAP RAMP CURB CUT W/ DETECTABLE WARNING
 - 15 MONUMENT SIGN
 - 16 ALL SIDEWALKS AND PAVING GRADES, CROSSLOPES & RAMPS SHALL COMPLY WITH THE LATEST EDITION OF THE FLORIDA ACCESSIBILITY CODE FOR BUILDING CONSTRUCTION.
 - 17 INSTALL CONTINUOUS 36" WIDE ADA DETECTABLE WARNING ALONG ALL SIDEWALKS FLUSH WITH PAVED TRAFFIC AREAS. SEE CIVIL DRAWINGS. INSTALL 6" DIA. GALV. STEEL PIPE BOLLARDS PAINTED, 42" HIGH, AT 5'-0" O.C. ALONG ENTIRE LENGTH.
 - 18 PROVIDE 4" PRECAST CONCRETE WHEELSTOP AT EVERY PARKING SPACE - SEE CIVIL DWGS.
 - 19 PROVIDE (30) TRASH RECEPTACLES AS SPECIFIED IN SECTION 10450-11. LOCATIONS TO BE PROVIDED BY ARCHITECT.
 - 20 PROVIDE 4" CONCRETE PAVING AT SOFTBALL, BASEBALL AND ALL RECREATION FIELD WALKWAYS PER SPECIFICATION SECTION 03300
 - 21 AT ALL GROUND MOUNTED MECHANICAL SYSTEMS, PROVIDE A 4" CONCRETE SLAB (PER SPECIFICATION SECTION 03300) WITH 3'-0" CLEARANCE ALL AROUND MECHANICAL UNITS AND A 6'-0" HIGH GALVANIZED CHAIN LINK FENCE WITH A PAIR OF 3'-0"x6'-0" GATES.

9510-005-01.dwg 1'-0", 07/26/01 at 1407